

## BELLISSIMO NICKEL SILVER - 3.2 mm

- Conical shaped temple in nickel silver
- Patented never-loose mechanism
- Various endpieces available
- Optionally delivered assembled with endpiece - screw 99-02030



patented

Catalogue 2026 | 2027 - Subject to change without prior notice - all measurements in mm

60-07058.29X with 20° opening angle  
 60-07058.19X with limited opening angle  
 Loose end piece: ELEPHANT 52-07058.600

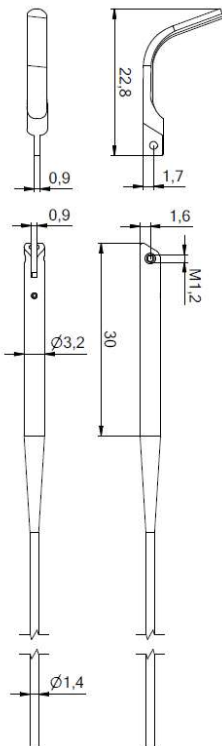

60-07058.39X.0Y  
 Assembled with SHORTY endpiece  
 Loose end piece: SHORTY 52-07058.200

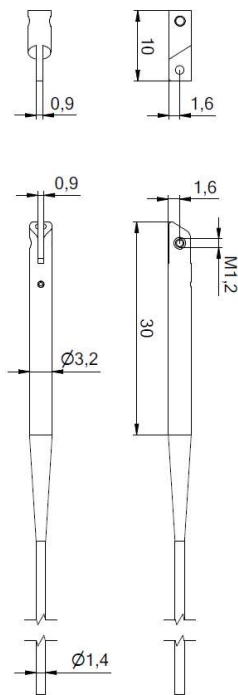

60-07058.49X.0Y  
 Assembled with SIDE DISH endpiece  
 Loose end piece: SIDE DISH 52-07058.400

