

TURN-MILL
TECHNOLOGY

MADE IN GERMANY

Accelerated Precision for advanced components



19512109

Turn-mill components just in time



Key Capabilities

- Complex geometries & tight tolerances
- Rapid prototyping & short-run production
- Multi-axis machining with main/sub spindle

Machining Specs

- Turning diameter: Ø 0.5 – 10 mm
- Max part length: up to 100 mm
- Tolerances: ±0.02 mm
- 8-axis, sub spindle with Y-axis

Materials

- Stainless steel 316L
- Others on request

Typical Components

- Precision screws, pins, nozzles
- Medical and dental parts
- Watch components
- Micro-mechanical parts

Applications

- **COMPLEX SCREW 1:**
Head: ø2.0mm - Length: 4.0 mm - Thread: M1.4

Precisely milled Torx® drive

Flat turned
head surface

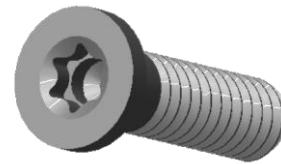

Controlled recess depth

- **COMPLEX SCREW 2:**
Head: ø 2.4 mm - Length: 6.1 mm - Thread: M1.2

Non threaded waist section

Polyhedral head
geometry



Lateral grooves

Thanks to short setup times and flexible planning, we deliver prototypes and small production batches reliably – and fast.

Facts about OBE:

Founded 1904 | 550 employees worldwide | Key supplier in eyewear |
4 facilities worldwide | ISO 9001:2015 | DIN EN ISO 14001 and EMAS